



Vestil Manufacturing Corp.

2999 North Wayne Street, P.O. Box 507, Angola, IN 46703

Telephone: (260) 665-7586 -or- Toll Free (800) 348-0868

Fax: (260) 665-1339

www.vestilmfg.com e-mail: info@vestil.com

**ELEC-2448-2 Electrical Supply Cart
Instruction Manual**

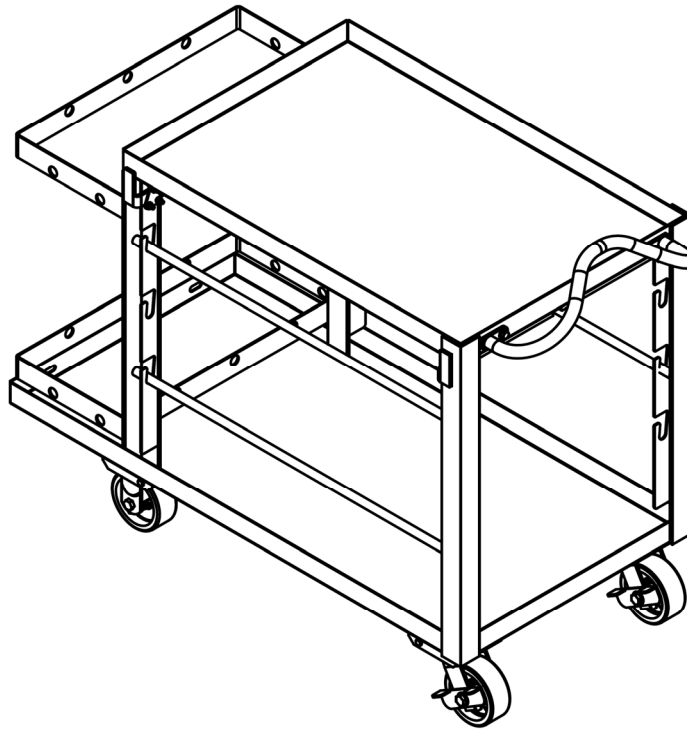

Receiving instructions:

After delivery, IMMEDIATELY remove the packaging from the product. Inspect the product closely to determine whether it sustained damage during transport. If damage is discovered, immediately record a complete description of the damage on the bill of lading. If the product is undamaged, discard the packaging.

NOTE:

Responsibility for complying with laws, regulations, codes, and non-voluntary standards enforced in the location where the product is used lies exclusively with the end-user.

Table of Contents

Specifications.....	2
Signal Words.....	2
Hazards of Improper Use.....	3
FIG. 1: Exploded parts diagram & bill of materials.....	3
Assembly.....	4 - 5
Using the cart.....	5
Maintenance.....	5
Labeling Diagram.....	6
Limited Warranty.....	7

Specifications:

Dimensions and other specifications appear in the diagrams and table below.

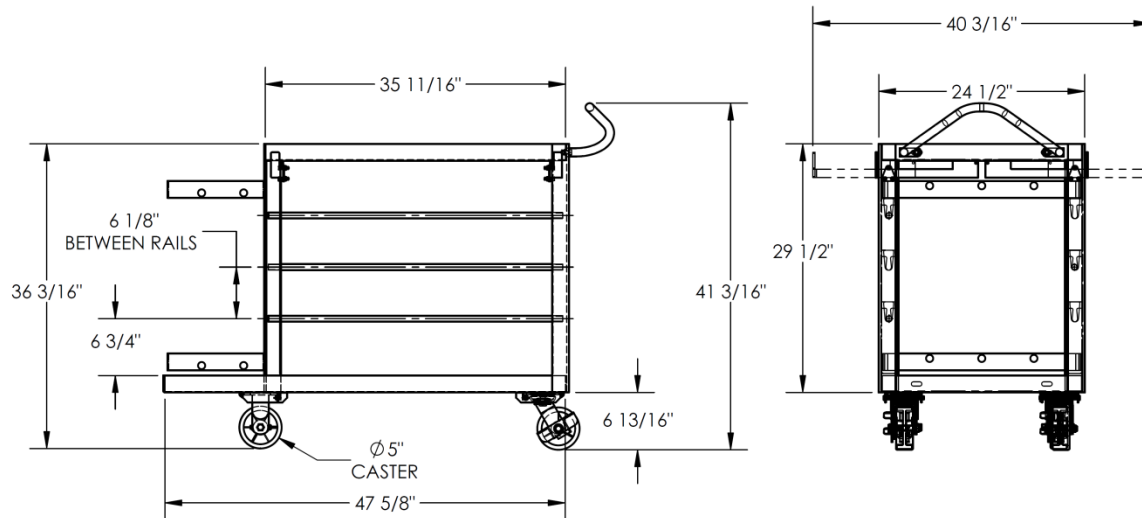

Maximum capacity: 1,000 lb.
 Front casters: 2 rigid 5" x 2" polyurethane-on-steel;
 Rear casters: 2 swivel 5" x 2" polyurethane-on-steel with brake
 Net weight: 171 lb. (77.4kg)

Signal Words:

This manual uses SIGNAL WORDS to indicate the likelihood of personal injuries, as well as the probable seriousness of those injuries, if the product is misused in the ways described. Other signal words call attention to uses of the product likely cause property damage. The signal words used appear below along with the meaning of each word:



Identifies a hazardous situation which, if not avoided, WILL result in DEATH or SERIOUS INJURY. Use of this signal word is limited to the most extreme situations.



Identifies a hazardous situation which, if not avoided, COULD result in DEATH or SERIOUS INJURY.



Indicates a hazardous situation which, if not avoided, COULD result in MINOR or MODERATE injury.



Identifies practices likely to result in product/property damage, such as operation that might damage the product.

Each person who assembles, installs, uses, or maintains this product should read the entire manual in advance and fully understand the directions. If after reading the manual you do not understand an instruction, ask your supervisor or employer for clarification, because failure to adhere to the directions in this manual might result in serious personal injury.

Hazards of Improper Use:

We strive to identify foreseeable hazards associated with the use of our products. However, material handling is inherently dangerous and no manual can address every risk.

WARNING

Improper or careless operation might result in serious personal injuries.

- **Failure to read and understand the entire manual before assembling, using, or servicing the product constitutes misuse.** Read the manual to refresh your understanding of proper use and maintenance procedures as necessary.
- DO NOT apply a load that weighs more than the maximum capacity of your cart. The capacity appears on label 287 as shown in “Labeling diagram” on p. 6 as well as in the “Specifications” section on p. 2.
- DO NOT allow people to climb or ride on the cart.
- DO NOT use the cart in corrosive environments.
- ONLY use the cart on compacted, improved surfaces capable of supporting the combined weight of the cart plus a full capacity load.
- If repairs are necessary, install only manufacturer-approved replacement parts.
- ALWAYS evenly distribute and balance loads applied to the cart. Counterbalance a load applied to a side arm by applying a load to the arm on the opposite side of the cart.
- Apply both caster locks whenever the cart is not moving.
- All loads applied to the cart must fit within the dimensions of the cart and arms.
- DO NOT use the cart unless it is in normal condition. (See “Maintenance” section of this manual).
- DO NOT use the cart UNLESS all labels are in place and readable (see “Labeling diagram” on p. 6).
- DO NOT modify this product in any way. Modifications automatically void the limited warranty and might make the cart unsafe to use.

NOTICE

Proper use and maintenance are essential for this product to function properly.

- Always use this product in accordance with the instructions in this manual.
- Periodically lubricate moving parts.
- Keep the product clean & dry.
- Only use approved replacement parts. To order replacement or spare parts for this equipment, contact the factory.

FIG. 1: Exploded Parts Diagram and Bill of Materials

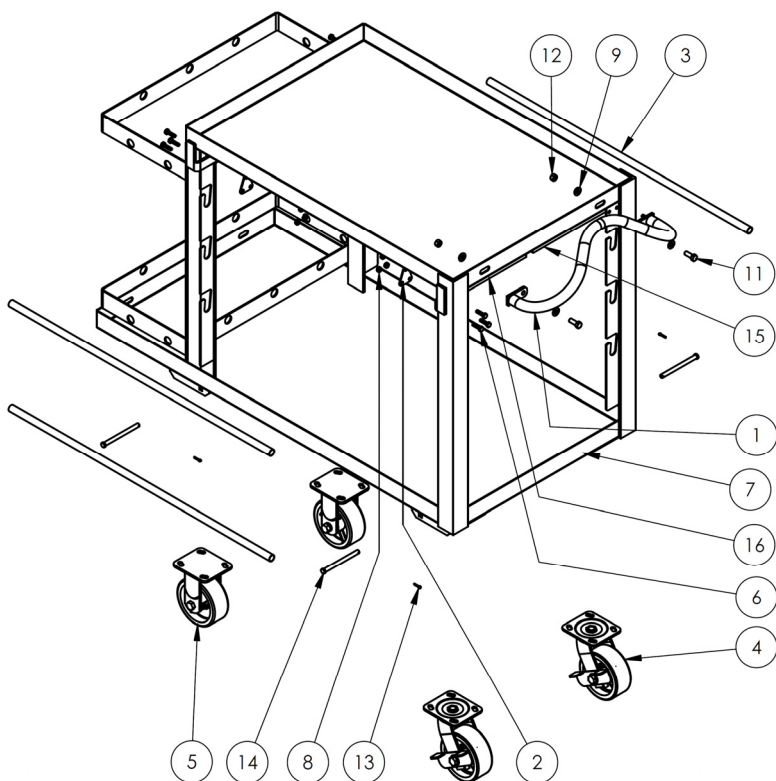

Item no.	Part no.	Description	Qty.
1	16-025-025	Handle, formed, ergo	1
2	33-016-120	Bracket, slide out bracket	4
3	33-014-335	Frame, coil bar	3
4	16-132-053	Swivel caster with brake, PU-5/2-S-SWB	2
5	16-132-022	Rigid caster, PU-5/2-R	2
6	11005	Bolt, 1/4" - 20UNC x 1" HHCS #2, zinc-plated	12
7	33-514-207	Weldment, frame	1
8	37018	Nylon lock nut, grade 2, zinc finish, 1/4" - 20	12
9	33008	Flat washer, 3/8", low carbon, USS, zinc-plated	4
10	33622	Split lock washer, carbon steel, medium zinc finish, 3/8"	2
11	11105	Hex bolt, grade A, zinc plated, 3/8" - 16 x 1"	2
12	36106	Hex nut, grade A, zinc plated, 3/8" - 16	2
13	65074	Pin, cotter	4
14	99-112-006	Pin, clevis	4
15	33-014-336	Frame, slide out, right	2
16	33-014-339	Frame, slide out, left	2

Assembly:

Step 1: Insert the caster plates into the receivers. Secure them in place with clevis pins and cotter pins as shown in the diagrams below. Apply the caster brakes by pushing the brake levers down.

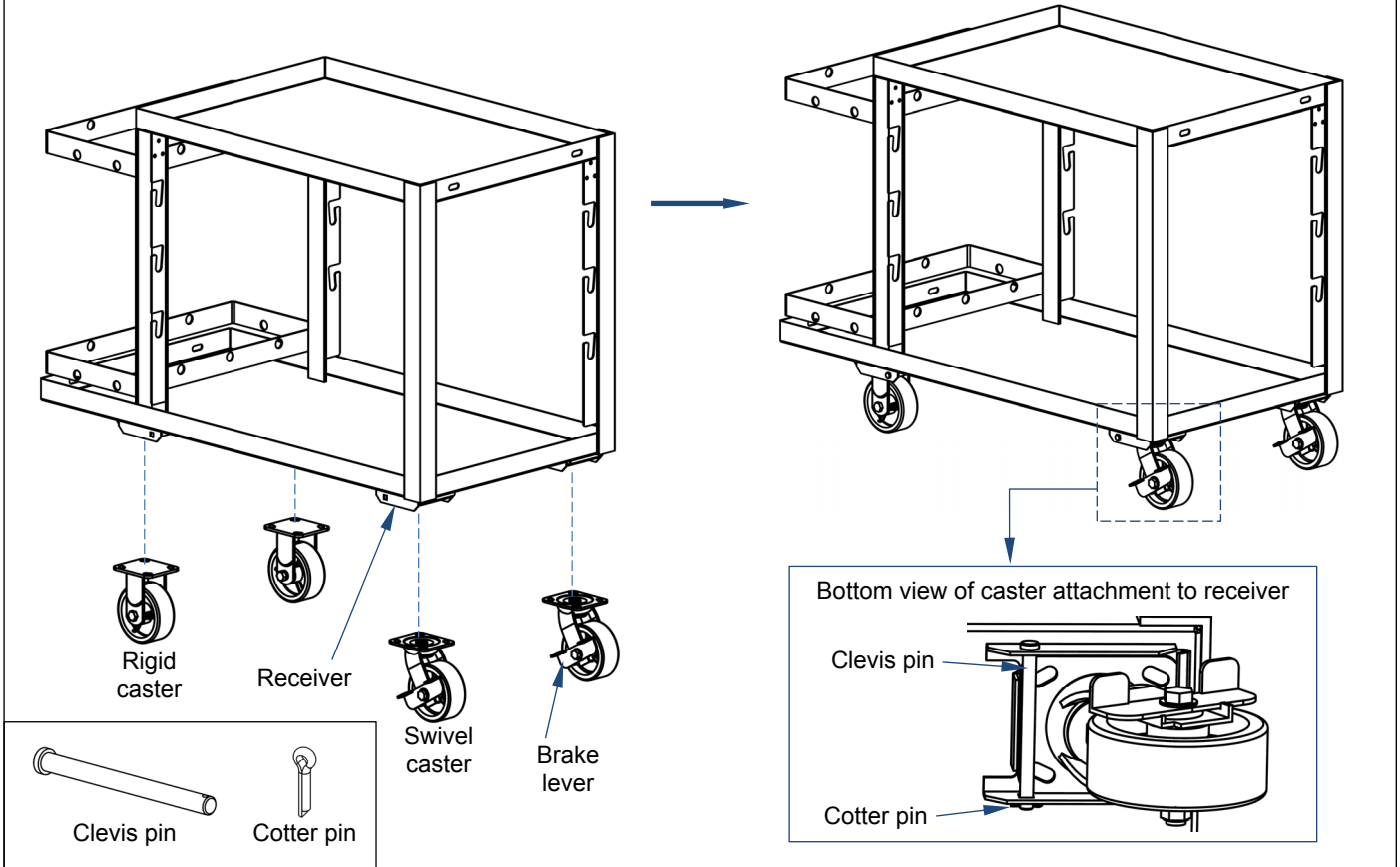

Step 2: Attach the slide arm brackets to the frame using 1/4" hardware. Hold each slide arm against the frame so that two bolt holes are visible below the arm and one hole is above it. Then, align a slide arm bracket with the bolt holes and install the hardware as diagrammed below. Numbers in parentheses correspond to item numbers in the bill of materials on page 3.

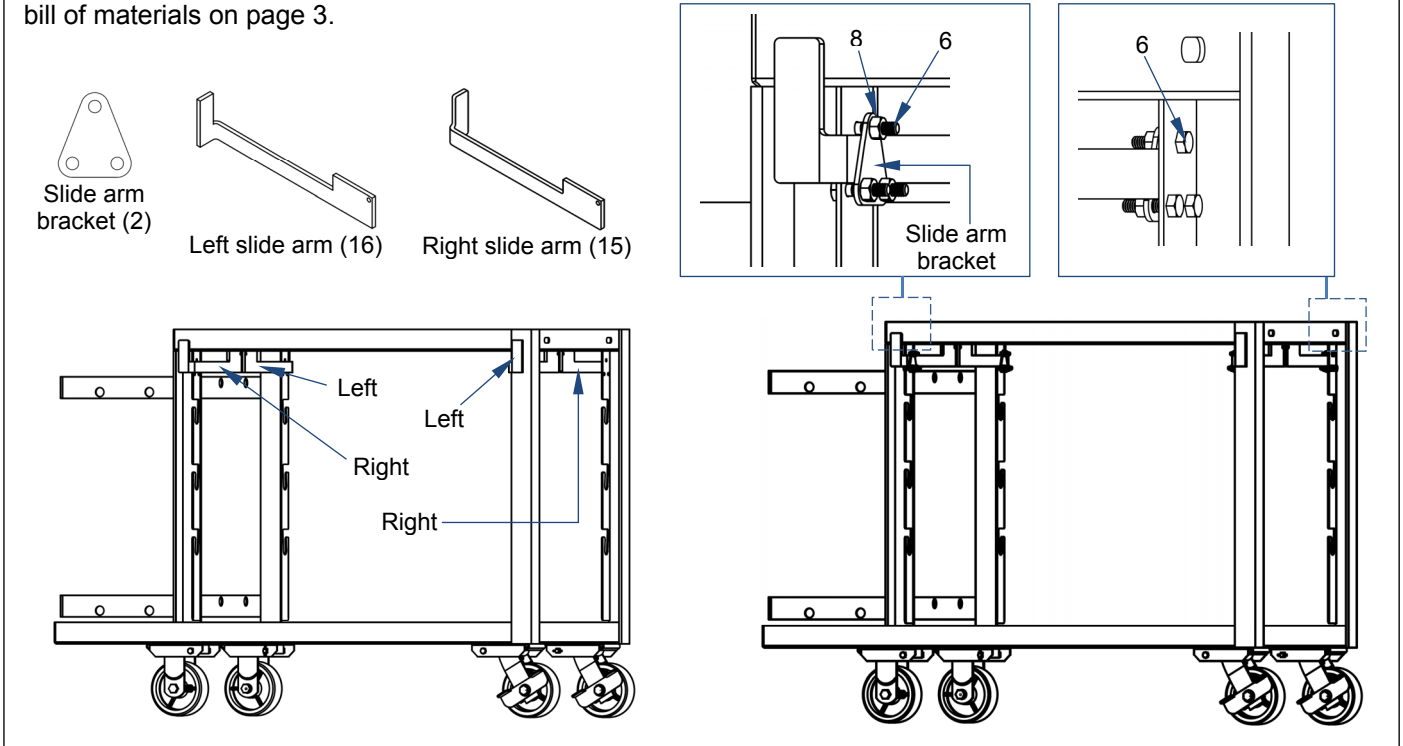

Step 3: Attach the handle to the frame with $\frac{3}{8}$ " hardware. Then, install the coil bars (3) into bar slots wherever desired.

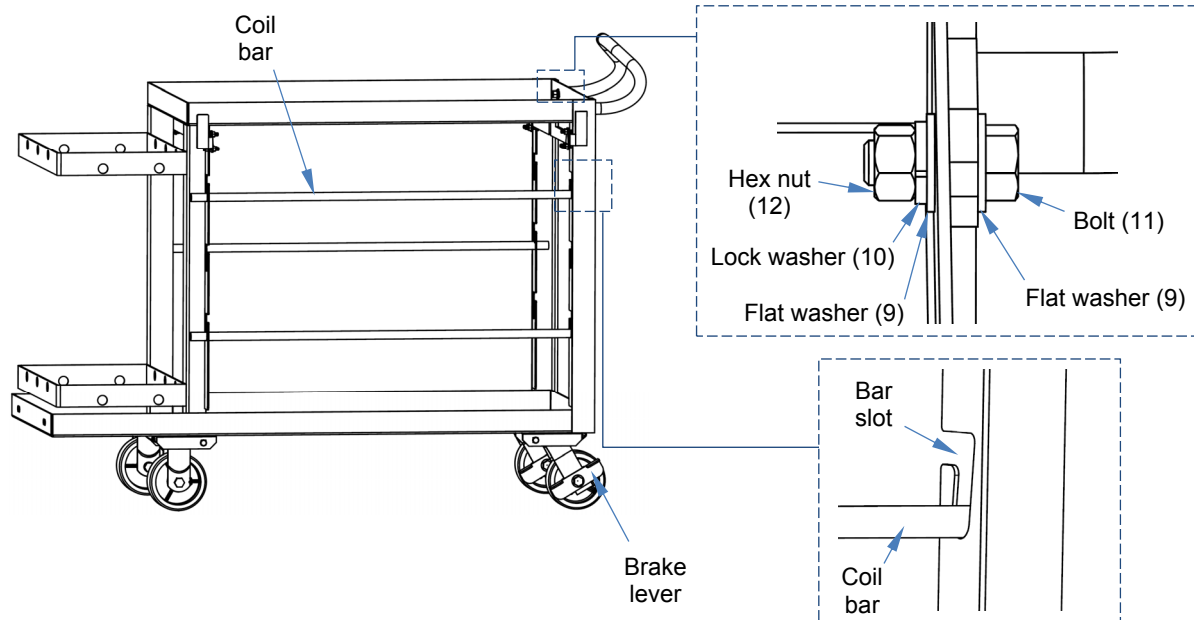

Using the cart:

This cart has a load capacity of 1,000 pounds, which is the maximum *net* weight the cart can support. Evenly distribute and balance loads applied to the cart. For instance, install spools of wire in pairs—one on the left side and the other on the right side. Only use a loaded cart on even, level floors.

Apply the caster brakes whenever the cart is not moving (see diagram in “Step 3” above). To apply the brakes, press down on the brake levers. Unlock the brakes by raising the brake levers.

Maintenance:

When the cart is first assembled, make a written record that describes its appearance. Be sure to describe the casters and sliding arms. This record establishes “normal condition”. During maintenance operations, compare the cart to the record to determine if it is in normal condition.

Implement a maintenance program to ensure that the product remains in normal condition for as long as possible. If a problem is discovered while performing maintenance on the cart, restore it to normal operating condition before returning it to service. Apply the following steps at least once per month, or more frequently if the cart is under heavy service.

1. Tag the cart, “Out of Service.”
2. Clean all surfaces.
3. Inspect the unit. If deformity, severe corrosion/rusting, or excessive wear is present, do not continue to use the cart.
 - a. Check shelves and coil bars for severe wear. Bars should be straight. Shelves should be rigidly welded to the frame.
 - b. Inspect each caster for looseness and severe wear. Push the cart a short distance to determine if all 4 casters roll smoothly. Confirm that each caster is securely retained in its receiver. Replace a caster if it is bent or broken. Check retaining clevis pins and cotter pins for damage.
 - c. Examine the handle. Make sure that it is securely fastened to the frame.
 - d. Inspect the slide arms. Make sure that they cannot pull free. Each arm should be straight and rigid, without cracks, bends, etc.
 - e. Tighten all fasteners (bolts, nuts) if necessary and replace damaged items.
4. Perform all necessary repairs but DO NOT modify the cart. A “modification” is a change that alters the cart from original condition, like bending the frame members or removing parts. Modifications automatically void the limited warranty and might make the cart unsafe to use.
5. Make a dated record of all work performed.

Labeling diagram:

The cart always should be labeled as shown below. Contact Vestil to order replacement labels.

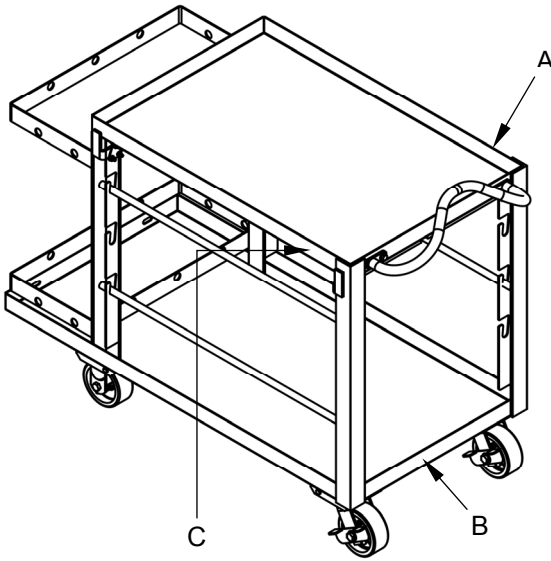

A: Label 287(data label)

MODEL/MODÉLO/MODÈLE _____
STATIC CAPACITY (evenly distributed) _____ lbs.
LA CAPACIDAD CONSTANTE (distribuida uniformemente) _____ kgs.
CAPACITÉ STATIQUE (distribuée régulièrement) _____ kgs.
SERIAL/SERIE/SÉRIE _____

287 REV 0812

B: Label 212 (Lock casters)

▲ WARNING	▲ ADVERTENCIA	▲ AVERTISSEMENT
LOCK CASTER and/or FLOOR LOCK when loading and unloading	La RUEDECILLA de la CERRADURA y/o el PISO CIERRAN al cargar y descargar	LOCK CASTER et/ou SOL LOCK lors du chargement et de déchargement

212 Rev 0111

C: Label 658

▲ WARNING	▲ ADVERTENCIA	▲ AVERTISSEMENT
Do not operate or move with unstable loads DO NOT LOAD beyond rated capacity DISTRIBUTE LOAD EVENLY DO NOT sit or ride	No use a mueva con cargas inestables No cargue mas de la capacidad tasada DISTRIBUYA LA CARGA A NIVEL NO SE SIENTE o vaya en el carro	Ne pas utiliser avec une charge instable NE PAS CHARGER au-delà du débit nominale DISTRIBUER la charge régulièrement NE PAS VOUS ASSEoir OU VOUS PROMENER sur le chariot

658
REV 0805

LIMITED WARRANTY

Vestil Manufacturing Corporation (“Vestil”) warrants this product to be free of defects in material and workmanship during the warranty period. Our warranty obligation is to provide a replacement for a defective original part **if** the part is covered by the warranty, after we receive a proper request from the warrantee (you) for warranty service.

Who may request service?

Only a warrantee may request service. *You are a warrantee if* you purchased the product from Vestil or from an authorized distributor AND Vestil has been fully paid.

What is an “original part”?

An original part is a part used to make the product as shipped to the warrantee.

What is a “proper request”?

A request for warranty service is proper if Vestil receives: 1) a photocopy of the Customer Invoice that displays the shipping date; AND 2) a written request for warranty service including your name and phone number. Send requests by any of the following methods:

<u>Mail</u>	<u>Fax</u>	<u>Email</u>
Vestil Manufacturing Corporation 2999 North Wayne Street, PO Box 507 Angola, IN 46703	(260) 665-1339 <u>Phone</u> (260) 665-7586	sales@vestil.com

In the written request, list the parts believed to be defective and include the address where replacements should be delivered.

What is covered under the warranty?

After Vestil receives your request for warranty service, an authorized representative will contact you to determine whether your claim is covered by the warranty. Before providing warranty service, Vestil may require you to send the entire product, or just the defective part or parts, to its facility in Angola, IN. The warranty covers defects in the following *original* dynamic components: motors, hydraulic pumps, electronic controllers, switches and cylinders. It also covers defects in *original* parts that wear under normal usage conditions (“wearing parts”), such as bearings, hoses, wheels, seals, brushes, and batteries.

How long is the warranty period?

The warranty period for original dynamic components is 90 days. For wearing parts, the warranty period is 90 days. The warranty periods begin on the date when Vestil ships the product to the warrantee. If the product was purchased from an authorized distributor, the periods begin when the distributor ships the product. Vestil may, at its sole discretion, extend the warranty periods for products shipped from authorized distributors by *up to* 30 days to account for shipping time.

If a defective part is covered by the warranty, what will Vestil do to correct the problem?

Vestil will provide an appropriate replacement for any *covered* part. An authorized representative of Vestil will contact you to discuss your claim.

What is not covered by the warranty?

1. Labor;
2. Freight;
3. Occurrence of any of the following, which automatically voids the warranty:
 - Product misuse;
 - Negligent operation or repair;
 - Corrosion or use in corrosive environments;
 - Inadequate or improper maintenance;
 - Damage sustained during shipping;
 - Collisions or other incidental contacts causing damage to the product;
 - Unauthorized modifications: DO NOT modify the product IN ANY WAY without first receiving written authorization from Vestil. Modification(s) might make the product unsafe to use or might cause excessive and/or abnormal wear.

Do any other warranties apply to the product?

Vestil Manufacturing Corp. makes no other express warranties. All implied warranties are disclaimed to the extent allowed by law. Any implied warranty not disclaimed is limited in scope to the terms of this Limited Warranty.

